

SS HD

**Handle material**

Die cast zinc

**Insert material**

Blackened steel or stainless steel boss and ratchet with allen key fixing screw.

**Male thread**

Steel or stainless steel.

**Handle colours**

Black handle as standard. Other RAL colours on request (MOQs apply).

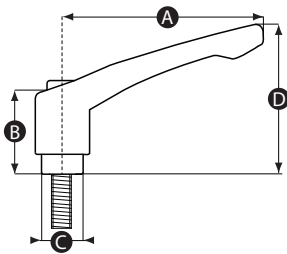

Part No.	A	B	C	D	Thread size	Thread length (mm)	Insert material
12075Q	42	25	10	37	M5	16	Blackened steel
12076X	42	25	10	37	M5	20	Blackened steel
12090W	42	25	10	37	M5	20	Stainless steel
12091S	42	25	10	37	M5	25	Stainless steel
12082V	42	25	10	37	M6	16	Blackened steel
12083R	42	25	10	37	M6	20	Blackened steel
12085U	42	25	10	37	M6	32	Blackened steel
12096U	42	25	10	37	M6	16	Stainless steel
12097Q	42	25	10	37	M6	20	Stainless steel
12099T	42	25	10	37	M6	32	Stainless steel
12104V	65	31	14	49	M6	25	Blackened steel
12105R	65	31	14	49	M6	32	Blackened steel
12118U	65	31	14	49	M6	32	Stainless steel
12119Q	65	31	14	49	M6	40	Stainless steel

*Continued overleaf »*

« Continued from overleaf

Part No.	A	B	C	D	Thread size	Thread length (mm)	Insert material
12108Q	65	31	14	49	M8	16	Blackened steel
12109X	65	31	14	49	M8	20	Blackened steel
12110T	65	31	14	49	M8	25	Blackened steel
12111P	65	31	14	49	M8	32	Blackened steel
12112W	65	31	14	49	M8	40	Blackened steel
12113S	65	31	14	49	M8	50	Blackened steel
12122P	65	31	14	49	M8	20	Stainless steel
12123W	65	31	14	49	M8	25	Stainless steel
12124S	65	31	14	49	M8	32	Stainless steel
12125Z	65	31	14	49	M8	40	Stainless steel
12126V	65	31	14	49	M8	50	Stainless steel
12128Y	78	36	16	57	M10	20	Blackened steel
12130Q	78	36	16	57	M10	32	Blackened steel
12131X	78	36	16	57	M10	40	Blackened steel
12132T	78	36	16	57	M10	50	Blackened steel
12135S	78	36	16	57	M10	20	Stainless steel
12137V	78	36	16	57	M10	32	Stainless steel
12138R	78	36	16	57	M10	40	Stainless steel
12142X	92	43	19	65	M10	20	Blackened steel
12144P	92	43	19	65	M10	32	Blackened steel
12145W	92	43	19	65	M10	40	Blackened steel
12146S	92	43	19	65	M10	50	Blackened steel
12160R	92	43	19	65	M10	50	Stainless steel
12161Y	92	43	19	65	M10	63	Stainless steel
12151U	92	43	19	65	M12	32	Blackened steel
12152Q	92	43	19	65	M12	40	Blackened steel
12153X	92	43	19	65	M12	50	Blackened steel
12154T	92	43	19	65	M12	63	Blackened steel
12165T	92	43	19	65	M12	32	Stainless steel
12166P	92	43	19	65	M12	40	Stainless steel

Continued on facing page »

« Continued from facing page

<b>Part No.</b>	<b>A</b>	<b>B</b>	<b>C</b>	<b>D</b>	<b>Thread size</b>	<b>Thread length (mm)</b>	<b>Insert material</b>
12167W	92	43	19	65	M12	50	Stainless steel
12168S	92	43	19	65	M12	63	Stainless steel
12171R	108	51	23	77	M16	40	Blackened steel
12176T	108	51	23	77	M16	40	Stainless steel