



**Material**

Die cast zinc

**Pin material**

Stainless steel - 316

**Finish**

Powder coated

**Colour**

Black

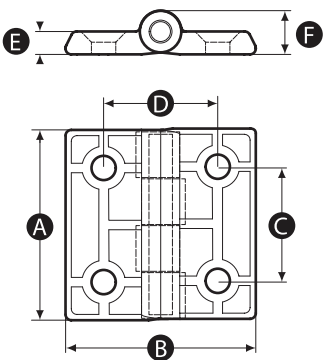

Part No.	A	B	C	D	E	F	Bore size (mm)
15765W	40	40	25	25	5	10	5.2
15750Q	50	50	30	30	6	12	6.4

Part No.	Radial load (N)	Axial load (N)	Recommended tightening torque (Nm)	Approx. shear force per screw (kN)
15765W	1250	2100	1.5	0.28
15750Q	1300	2200	2.5	0.5