

MODEL 108

Insteekdop rond
met schroefdraad

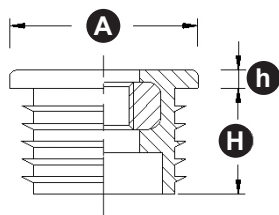

| Artikelnummer | A= Buis Uitwendig (mm) | Wanddikte buis (mm) | Doorlopend draadgat | h (mm) | H (mm) | VPE |
|---------------|------------------------|---------------------|---------------------|--------|--------|-----|
| 27000 | 19 | 1,0 - 2,0 | M 6 | 5 | 20 | 50 |
| 27005 | 20 | 1,0 - 2,0 | M 6 | 5 | 20 | 50 |
| 27010 | 20 | 1,0 - 2,0 | M 8 | 5 | 20 | 50 |
| 27015 | 25 | 1,0 - 2,0 | M 6 | 5 | 20 | 50 |
| 27020 | 25 | 1,0 - 2,0 | M 8 | 5 | 20 | 50 |
| 27025 | 30 | 1,0 - 2,0 | M 8 | 5 | 20 | 50 |
| 27030 | 30 | 1,0 - 2,0 | M 10 | 5 | 20 | 50 |
| 27035 | 32 | 1,0 - 2,0 | M 8 | 5 | 20 | 50 |
| 27040 | 32 | 1,0 - 2,0 | M 10 | 5 | 20 | 50 |
| | | | | 5 | 20 | |
| 27045 | 35 | 1,0 - 2,0 | M 8 | 5 | 20 | 25 |
| 27050 | 35 | 1,0 - 2,0 | M 10 | 5 | 20 | 25 |
| 27055 | 38 | 1,0 - 2,0 | M 8 | 5 | 20 | 25 |
| 27060 | 38 | 1,0 - 2,0 | M 10 | 5 | 20 | 25 |
| 27065 | 38 | 1,0 - 2,0 | M 12 | 5 | 20 | 25 |
| 27070 | 40 | 1,0 - 2,0 | M 8 | 5 | 20 | 25 |
| 27075 | 40 | 1,0 - 2,0 | M 10 | 5 | 20 | 25 |
| 27080 | 40 | 1,0 - 2,0 | M 12 | 5 | 20 | 25 |
| | | | | 5 | 20 | |
| 27085 | 50 | 1,0 - 2,0 | M 8 | 5 | 20 | 10 |
| 27090 | 50 | 1,0 - 2,0 | M 10 | 5 | 20 | 10 |
| 27095 | 50 | 1,0 - 2,0 | M 12 | 5 | 20 | 10 |
| 27100 | 60 | 1,0 - 2,0 | M 8 | 5 | 20 | 10 |
| 27105 | 60 | 1,0 - 2,0 | M 10 | 5 | 20 | 10 |
| 27110 | 60 | 1,0 - 2,0 | M 12 | 5 | 20 | 10 |

Technische gegevens: Deze insteekdoppen worden vervaardigd uit polyethyleen en zijn standaard zwart.

Deze insteekdoppen zijn voorzien van stalen bus.

Materiaal draadgat: staal verzinkt