

MODEL 11

Insteekdop rechthoekig

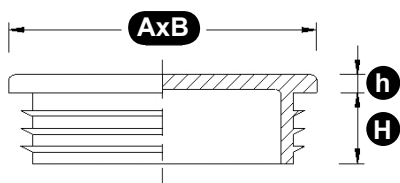

| Artikelnummer | A x B = buis uitwendig (mm) | Wanddikte buis (mm) | H (mm) | h (mm) | VPE |
|---------------|-----------------------------|---------------------|--------|--------|-----|
| 84900 | 15 x 10 | 1,0 - 2,0 | 11,5 | 4,5 | 100 |
| 84910 | 20 x 10 | 1,0 - 2,0 | 11,5 | 3 | 100 |
| 84920 | 20 x 15 | 1,0 - 2,0 | 11,3 | 5 | 100 |
| 85000 | 25 x 10 | 0,8 - 2,0 | 11,5 | 3 | 100 |
| 84930 | 25 x 15 | 1,0 - 3,0 | 11,8 | 4,9 | 100 |
| 84935 | 25 x 20 | 1,0 - 3,0 | 11,5 | 5 | 100 |
| 85001 | 30 x 10 | 1,0 - 1,5 | 12,0 | 5 | 100 |
| 85002 | 30 x 15 | 1,0 - 3,0 | 11,5 | 5 | 100 |
| 85003 | 30 x 20 | 1,0 - 3,0 | 11,5 | 5 | 100 |
| 84940 | 30 x 25 | 1,0 - 2,0 | 13,6 | 5,1 | 100 |
| 85020 | 35 x 16 | 1,0 - 3,0 | 11,5 | 4 | 100 |
| 84945 | 35 x 20 | 1,0 - 2,0 | 14,1 | 4,9 | 100 |
| 84950 | 35 x 25 | 1,0 - 3,0 | 11,5 | 5 | 100 |
| 84955 | 35 x 30 | 1,0 - 2,0 | 14,5 | 5 | 100 |
| 84960 | 40 x 10 | 1,0 - 2,0 | 15,0 | 5 | 100 |
| 84965 | 40 x 15 | 1,0 - 2,0 | 11,7 | 5 | 100 |
| 85004 | 40 x 20 | 1,0 - 3,0 | 11,5 | 5 | 100 |
| 85025 | 40 x 25 | 1,0 - 3,0 | 11,7 | 4,8 | 100 |
| 85007 | 40 x 30 | 1,0 - 3,0 | 11,5 | 5 | 100 |
| 84970 | 45 x 15 | 1,0 - 2,0 | 11,1 | 4,8 | 100 |
| 84975 | 45 x 20 | 1,0 - 3,0 | 11,5 | 5 | 100 |
| 84980 | 45 x 25 | 1,0 - 2,0 | 12,5 | 5 | 100 |
| 84985 | 50 x 15 | 1,0 - 2,0 | 13,6 | 4,7 | 100 |
| 85008 | 50 x 20 | 1,0 - 3,0 | 11,5 | 5 | 100 |
| 85009 | 50 x 25 | 1,0 - 3,0 | 11,5 | 5 | 100 |
| 84990 | 50 x 30 | 1,0 - 2,0 | 13,6 | 4,6 | 100 |
| 84995 | 50 x 40 | 1,0 - 2,0 | 12,2 | 5,3 | 100 |
| 85035 | 55 x 35 | 1,0 - 2,0 | 14,5 | 5 | 100 |
| 85040 | 60 x 20 | 1,0 - 3,0 | 14,5 | 5 | 100 |
| 85045 | 60 x 25 | 1,0 - 2,0 | 14,5 | 5 | 100 |
| 85011 | 60 x 30 | 1,0 - 3,0 | 14,5 | 5 | 100 |
| 85012 | 60 x 30 | 2,0 - 4,0 | 14,5 | 5 | 100 |
| 85014 | 60 x 40 | 1,0 - 2,0 | 15,2 | 6,2 | 50 |
| 85013 | 60 x 40 | 2,0 - 4,0 | 14,5 | 5 | 50 |
| 85023 | 60 x 50 | 1,5 - 3,5 | 14,5 | 5 | 50 |

Technische gegevens: Deze insteekdoppen worden vervaardigd uit LD polyethyleen en zijn standaard zwart. Ze zijn voorzien van horizontale lamellen rondom voor optimale grip in de buis.

MODEL 11

Insteekdop rechthoekig

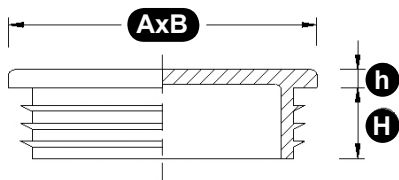

| Artikelnummer | A x B = buis uitwendig (mm) | Wanddikte buis (mm) | H (mm) | h (mm) | VPE |
|---------------|-----------------------------|---------------------|--------|--------|-----|
| 85015 | 70 x 25 | 1,5 - 2,0 | 13,0 | 5 | 50 |
| 85050 | 70 x 30 | 1,0 - 2,0 | 14,0 | 7 | 50 |
| 85055 | 70 x 40 | 1,0 - 2,0 | 17,9 | 5,7 | 50 |
| 85057 | 70 x 40 | 2,0 - 4,0 | 17,9 | 5,7 | 50 |
| 85060 | 80 x 20 | 1,0 - 2,0 | 17,9 | 6 | 50 |
| 85065 | 80 x 30 | 2,5 - 4,0 | 14,5 | 5 | 50 |
| 85016 | 80 x 40 | 2,0 - 4,0 | 14,5 | 5 | 50 |
| 85018 | 80 x 50 | 2,0 - 4,0 | 22,0 | 5 | 50 |
| 85070 | 80 x 60 | 1,5 - 3,0 | 24,0 | 5 | 50 |
| 85075 | 100 x 40 | 1,5 - 3,0 | 14,5 | 5 | 25 |
| 85019 | 100 x 50 | 2,0 - 4,0 | 18,5 | 8 | 25 |
| 85021 | 100 x 60 | 2,5 - 5,0 | 24,5 | 6 | 25 |
| 85080 | 100 x 80 | 3,0 - 5,0 | 24,0 | 6 | 25 |
| 85085 | 120 x 40 | 3,0 - 5,0 | 17,0 | 5,2 | 25 |
| 85090 | 120 x 60 | 1,5 - 3,0 | 24,2 | 5 | 25 |
| 85030 | 120 x 80 | 1,5 - 3,0 | 24,5 | 5 | 25 |
| 85095 | 140 x 80 | 2,0 - 4,0 | 24,5 | 5 | 25 |

Technische gegevens: Deze insteekdoppen worden vervaardigd uit LD polyethyleen en zijn standaard zwart. Ze zijn voorzien van horizontale lamellen rondom voor optimale grip in de buis.