

HD SS

Material

Stainless steel

Finish

Matt

Thread

Machined thread

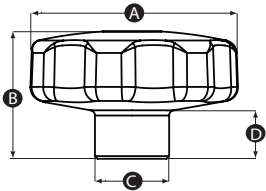

Part No.	A	B	C	D	Thread size
12714X	40	24	14	8	M6
12715T	40	24	14	8	M8
12716P	50	31	18	10	M8
12717W	50	31	18	10	M10
12718S	60	39	20	14	M10
12719Z	60	39	20	14	M12