

**SS HD**

**Handle material**

Die cast zinc

**Insert material**

Blackened steel or stainless steel boss and ratchet with allen key fixing screw.

**Handle colours**

Black handle as standard. Other RAL colours on request (MOQs apply).

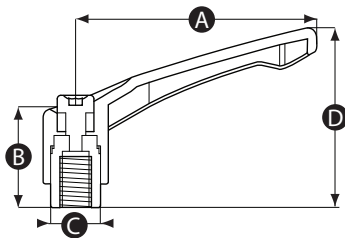

Part No.	A	B	C	D	Thread size	Insert material
12660T	42	25	10	37	M4	Blackened steel
12054X	42	25	10	37	M5	Blackened steel
12055T	42	25	10	37	M6	Blackened steel
12057W	42	25	10	37	M6	Stainless steel
12058S	65	31	14	49	M6	Blackened steel
12060V	65	31	14	49	M6	Stainless steel
12059Z	65	31	14	49	M8	Blackened steel
12061R	65	31	14	49	M8	Stainless steel
12062Y	78	36	16	57	M8	Blackened steel
12064Q	78	36	16	57	M8	Stainless steel
12063U	78	36	16	57	M10	Blackened steel
12065X	78	36	16	57	M10	Stainless steel
12066T	92	43	19	65	M10	Blackened steel
12068W	92	43	19	65	M10	Stainless steel
12067P	92	43	19	65	M12	Blackened steel

*Continued overleaf »*

« Continued from overleaf

<b>Part No.</b>	<b>A</b>	<b>B</b>	<b>C</b>	<b>D</b>	<b>Thread size</b>	<b>Insert material</b>
12069S	92	43	19	65	M12	Stainless steel
12070Z	108	51	23	77	M12	Blackened steel
12072R	108	51	23	77	M12	Stainless steel
12071V	108	51	23	77	M16	Blackened steel
12073Y	108	51	23	77	M16	Stainless steel