



**Handle material**

Reinforced nylon (15% glass filled PA6)

**Male thread material**

Zinc plated steel as standard. Stainless steel available on request (MOQs apply).

**Standard colour combinations**

Black handle with black cap.

**Options**

Also available with caps in red, black, grey, white, blue, green, yellow or orange (MOQs apply). Other handle RAL colours available on request (MOQs apply).

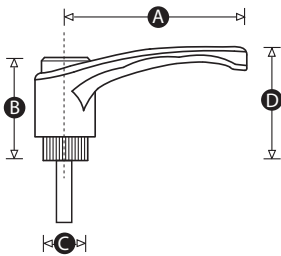

Part No.	A	B	C	D	Thread size	Thread length (mm)	Insert material	Handle + cap colour
11580Q	43	29	12	30	M5	15	Steel	Black + Black
11581X	43	29	12	30	M5	20	Steel	Black + Black
11582T	43	29	12	30	M5	25	Steel	Black + Black
11583P	43	29	12	30	M6	15	Steel	Black + Black
11584W	43	29	12	30	M6	20	Steel	Black + Black
11585W	43	29	12	30	M6	25	Steel	Black + Black
15283Z	43	29	12	30	M6	40	Steel	Black + Black
11586Z	65	38	15	44	M8	20	Steel	Black + Black
11587V	65	38	15	44	M8	30	Steel	Black + Black
11588R	65	38	15	44	M8	40	Steel	Black + Black
11589Y	65	38	15	44	M8	50	Steel	Black + Black
11590U	83	47	19	54	M10	30	Steel	Black + Black
11591Q	83	47	19	54	M10	40	Steel	Black + Black
11592X	83	47	19	54	M10	50	Steel	Black + Black

Continued overleaf »

« Continued from overleaf

<b>Part No.</b>	<b>A</b>	<b>B</b>	<b>C</b>	<b>D</b>	<b>Thread size</b>	<b>Thread length (mm)</b>	<b>Insert material</b>	<b>Handle + cap colour</b>
11593T	104	56	24	64	M12	30	Steel	Black + Black
11594P	104	56	24	64	M12	35	Steel	Black + Black
11595W	104	56	24	64	M12	50	Steel	Black + Black
11596S	104	56	24	64	M16	35	Steel	Black + Black
11597Z	104	56	24	64	M16	50	Steel	Black + Black